

R0330DAA

Figure 313. Front Wheel Hub and Drum Assembly (M939, M939A1).

(1) ITEM NO.	(2) SMR CODE	(3) NSN	(4) CAGEC	(5) PART NUMBER	(6) DESCRIPTION AND USABLE ON CODE (UOC)	(7) QTY
GROUP 1311 WHEEL ASSEMBLY.						
FIG. 313. FRONT WHEEL HUB AND DRUM ASSEMBLY (M939, M939A1).						
1	PAFZZ	5310-00-273-7771	78500	1199G111	WHEEL STUD,L.H. NUT,PLAIN,SINGLE BA UOC: DAC,DAD,DAE,DAF,DAG,DAH,DAJ,DAL ,DAW,DAX,V14,V15,V16,V17,V18,V19,V20,V2 1,V22,V24	10
1	PAFZZ	5310-00-880-2005	58536	A52427-R-1.125	WHEEL STUD,R.H. NUT,PLAIN,SINGLE BA UOC: V39	10
1	PAFZZ	5310-01-270-5463	58536	A52427-L-1.125	WHEEL STUD,L.H. NUT,PLAIN,SINGLE BA UOC: V39	10
1	PAFZZ	5310-01-375-3107	3D6E9	1199H112	WHEEL STUD,R.H. NUT,PLAIN,HEXAGON UOC: DAC,DAD,DAE,DAF,DAG,DAH,DAJ,DAL ,DAW,DAX,V14,V15,V16,V17,V18,V19,V20,V2 1,V22,V24	10
2	PAFZZ	2530-00-693-1029	58536	A-A-57174-1	L.H. NUT,CAP,DUAL WHEEL UOC: V39	10
2	PAFZZ	2530-00-359-1162	58536	A-A-57174-2	R.H. NUT,CAP,DUAL WHEEL UOC: V39	10
3	PAFZZ	2530-00-741-1105	19207	7411105	ADAPTER,BRAKE DRUM UOC: DAC,DAD,DAE,DAF,DAG,DAH,DAJ,DAL ,DAW,DAX,V14,V15,V16,V17,V18,V19,V20,V2 1,V22,V24	2
4	PAFZZ	5306-00-182-9267	19207	10896726	BOLT,MACHINE UOC: DAC,DAD,DAE,DAF,DAG,DAH,DAJ,DAL ,DAW,DAX,V14,V15,V16,V17,V18,V19,V20,V2 1,V22,V24	20
5	PAFZZ	5310-00-003-4094	80205	MS35338-48	WASHER,LOCK UOC: DAC,DAD,DAE,DAF,DAG,DAH,DAJ,DAL ,DAW,DAX,V14,V15,V16,V17,V18,V19,V20,V2 1,V22,V24	20
6	PAFZZ	2520-00-734-6991	19207	7346991	FLANGE,COMPANION,VE UOC: DAC,DAD,DAE,DAF,DAG,DAH,DAJ,DAL ,DAW,DAX,V14,V15,V16,V17,V18,V19,V20,V2 1,V22,V24	2
7	PAFZZ	5340-00-734-6992	19207	7346992	. PLUG,EXPANSION UOC: DAC,DAD,DAE,DAF,DAG,DAH,DAJ,DAL ,DAW,DAX,V14,V15,V16,V17,V18,V19,V20,V2 1,V22,V24	1
8	PAFZZ	5331-00-291-3273	81343	MS29513-229	. O-RING UOC: DAC,DAD,DAE,DAF,DAG,DAH,DAJ,DAL ,DAW,DAX,V14,V15,V16,V17,V18,V19,V20,V2 1,V22,V24	1

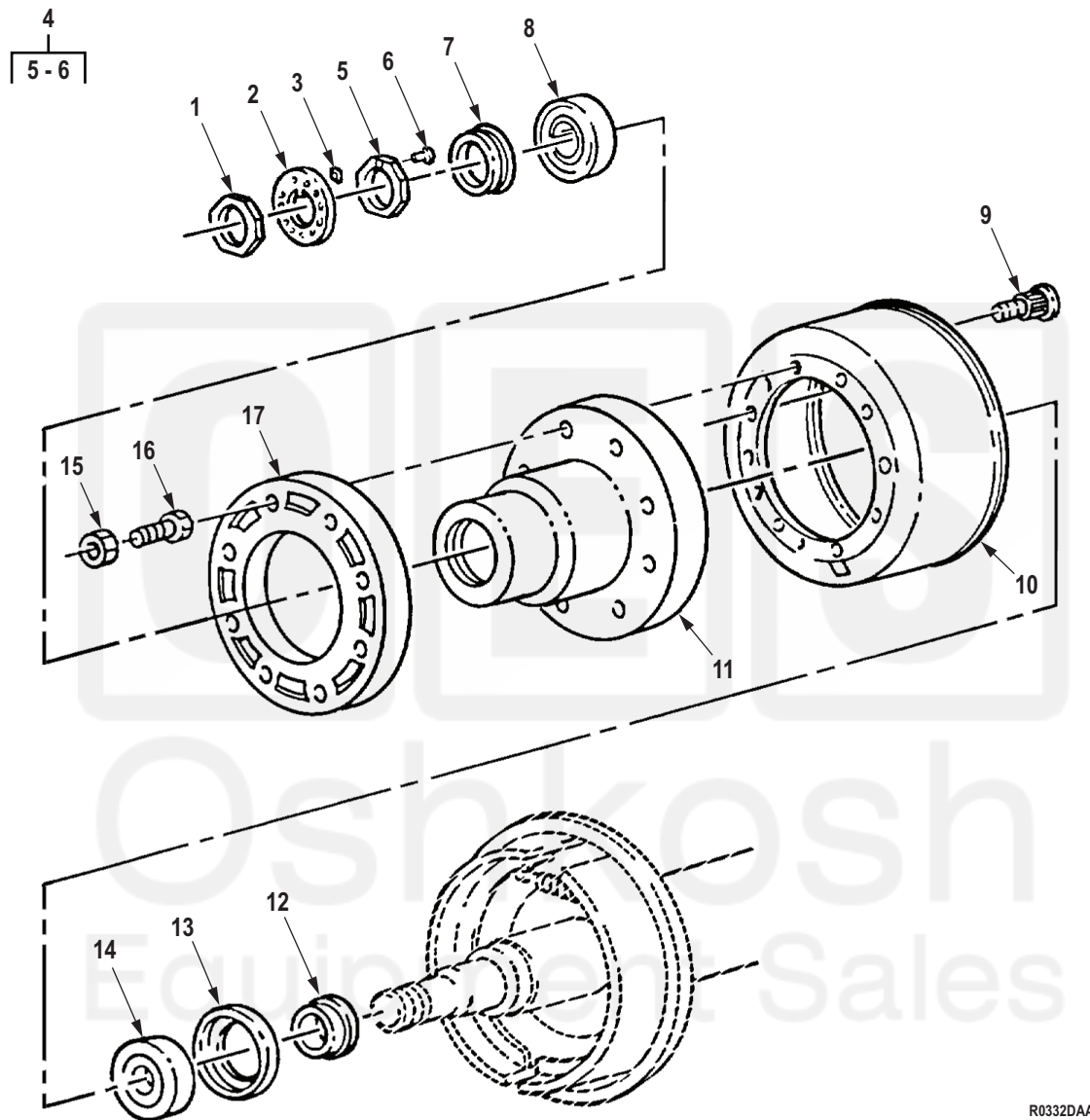

R0332DAA

Figure 315. Rear Wheel Hub and Drum Assembly (M939, M939A1)

(1) ITEM NO.	(2) SMR CODE	(3) NSN	(4) CAGEC	(5) PART NUMBER	(6) DESCRIPTION AND USABLE ON CODE (UOC)	(7) QTY
9	PAFZZ	5307-01-135-9290	78500	20X-1527	STUD UOC: V39	20
10	PAFZZ	2530-01-260-0695	19207	12470150	BRAKE DRUM UOC: DAC,DAD,DAE,DAF,DAG,DA H,DAJ,DAL,DAW,DAX,V14,V15,V16, V17,V18,V19,V20,V21,V22,V24	2
11	PAFZZ	2530-00-740-9395	19207	7409395	HUB CAPS WHEEL UOC: DAC,DAD,DAE,DAF,DAG,DA H,DAJ,DAL,DAW,DAX,V14,V15,V16, V17,V18,V19,V20,V21,V22,V24	2
12	PAFZZ	2590-00-740-9553	19207	7409553	RING,WIPER UOC: DAC,DAD,DAE,DAF,DAG,DA H,DAJ,DAL,DAW,DAX,V14,V15,V16, V17,V18,V19,V20,V21,V22,V24	2
13	PAFZZ	5330-00-740-9550	19207	7979349	SEAL,PLAIN ENCASED INNER WHEEL BEARING UOC: DAC,DAD,DAE,DAF,DAG,DA H,DAJ,DAL,DAW,DAX,V14,V15,V16, V17,V18,V19,V20,V21,V22,V24	2
14	PAFZZ	3110-00-689-8250	58536	AA59649-643	BEARING,ROLLER,TAPE UOC: DAC,DAD,DAE,DAF,DAG,DA H,DAJ,DAL,DAW,DAX,V14,V15,V16, V17,V18,V19,V20,V21,V22,V24	2
15	PAFZZ	5310-01-375-3107	3D6E9	1199H112	NUT,PLAIN,HEXAGON WHEEL STUD,RIGHT HAND UOC: DAC,DAD,DAE,DAF,DAG,DA H,DAJ,DAL,DAW,DAX,V14,V15,V16, V17,V18,V19,V20,V21,V22,V24	10
15	PAFZZ	5310-00-273-7771	78500	1199G111	NUT,PLAIN,SINGLE BA WHEEL STUD,LEFT HAND UOC: DAC,DAD,DAE,DAF,DAG,DA H,DAJ,DAL,DAW,DAX,V14,V15,V16, V17,V18,V19,V20,V21,V22,V24	10
15	PAFZZ	5310-01-270-5463	58536	A52427-L-1.125	NUT,PLAIN,SINGLE BA WHEEL STUD,LEFT HAND UOC: V22,V24	20
15	PAFZZ	5310-00-880-2005	58536	A52427-R-1.125	NUT,PLAIN,SINGLE BA WHEEL STUD,RIGHT HAND UOC: V22,V24	20
16	PAFZZ	2530-00-359-1162	58536	A-A-57174-2	NUT,CAP,DUAL WHEEL RIGHT HAND UOC: V22,V24	20
16	PAFZZ	2530-00-693-1029	58536	A-A-57174-1	NUT,CAP,DUAL WHEEL LEFT HAND UOC: V22,V24	20